

26 GA. PBR LOAD TABLE OVER PLYWOOD

GULF COAST

Buildings having a Roof Mean Height \leq 20'-0"; Roof Slope: 2"/12" -6"/12" Gable Roof
Wind Speeds 120-150 mph, Exp C, I = 1.0, based on FLORIDA BUILDING CODE 2007

26 GA. PBR FASTENER SPACING						
ZONE	FASTENER	SUBSTRATE	WIND SPEED ZONE			
			120	130	140	150
			ON CENTER SPACING	ON CENTER SPACING	ON CENTER SPACING	ON CENTER SPACING
ZONE 1	#9-15-1-1/2"	15/32" CDX/ 19/32" CDX	24" TYPE 1	24" TYPE 1	24" TYPE 1	24" TYPE 1
ZONE 2	#9-15-1-1/2"	15/32" CDX/ 19/32" CDX	24" TYPE 1	12" TYPE 2	12" TYPE 2	12" TYPE 2
ZONE 3	#9-15-1-1/2"	15/32" CDX/ 19/32" CDX	12" TYPE 2	12" TYPE 2	12" TYPE 2	12" TYPE 2

- PANEL DESCRIPTION:** PBR, MIN. 26 GA. GRADE 80, 36" COVERAGE, 1-1/4" TALL.
- PANEL ROLLFORMER:** MRS METAL ROLLFORMING SYSTEMS.
- PANEL FASTENER:** (1) #9-15 x 1-1/2" WOODGRIP W/ SEALING WASHER.
- MAXIMUM ALLOWABLE PANEL UPLIFT PRESSURE:** 60.5 PSF @ 24" FASTENER SPACING TYPE 1 FASTENER PATTERN, 154.75 PSF @ 12" FASTENER SPACING TYPE 2 FASTENER PATTERN BASED ON TAS 125, UL 580/UL 1897 TESTING.
- PLYWOOD DECKING:** MIN. 15/32" PLYWOOD. PLYWOOD MUST BE DESIGNED IN ACCORDANCE WITH FBC 2007.

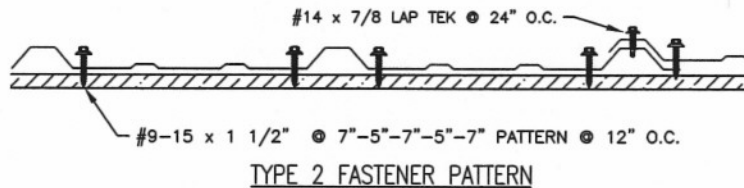
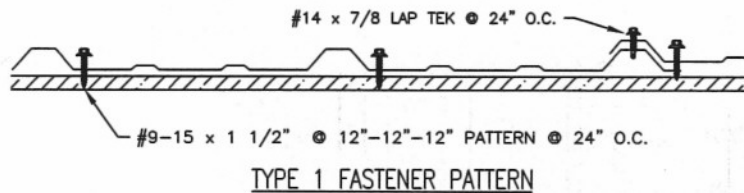

State of Florida
C.O.A.
26778

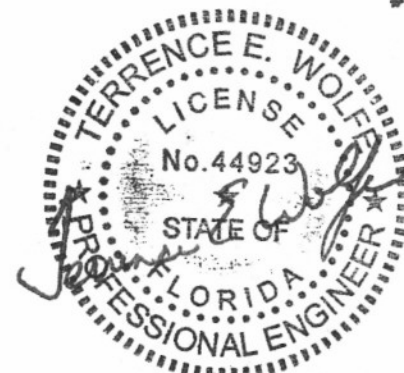
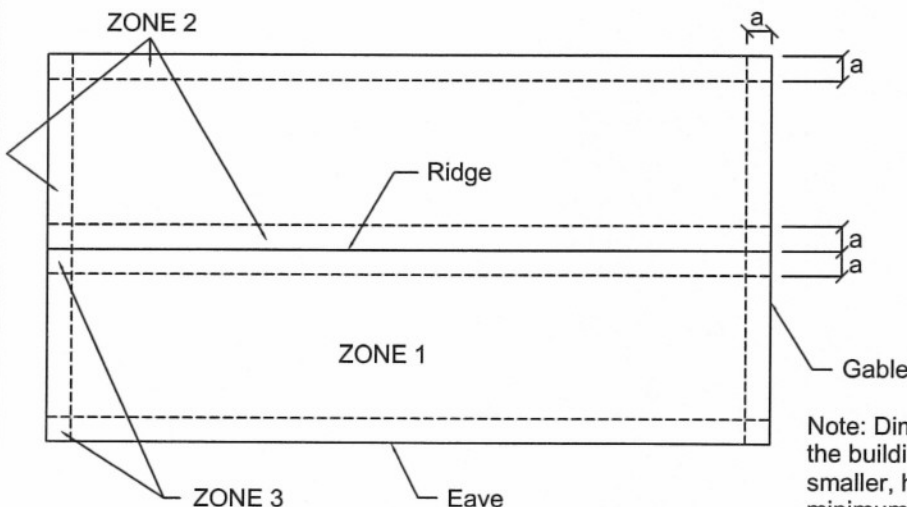

NOV 08 2008

Note: Dimension (a) is defined as 10% of the minimum width of the building or 40% of the mean height of the roof, whichever is smaller, however, (a) cannot be less than either 4% of the minimum width of the building or 3 feet.